

Installation Instructions



JL/JK/Bronco® Tailgate Table Part #: S/B2893



For Technical Support / Warranty Information please call **800-776-0767** or email info@smittybilt.com
1017 W 600 N, STE 4, Ogden, UT 84404

Introduction

Thank you for choosing Smittybilt accessories for your Jeep® or Bronco®. If you would like to view our full range of available accessories, please visit us at www.smittybilt.com



10.6CFM Dual Head Compressor



Winches



XL Hardshell Tent

Jeep®, Wrangler®, JK®, and JL® are registered trademarks of Stellantis N.V.
Ford® and Bronco® are registered trademarks of Ford Motor Company

Important Notes Before Starting

! IMPORTANT NOTE

Carefully read through this entire instruction manual thoroughly before attempting to install this part. Check that all fasteners are properly torqued after installation and after 50 miles of driving. All hardware should be checked every 4-6 months and be retorqued as needed.

! WARNING

Serious injury can occur when working on vehicles alone.

When possible, work with another person to reduce risk of injury from strain or other dangers that can occur when working alone.

TOOLS REQUIRED

Metric Allen Wrench Set	Metric Wrench Set	Drill
23/64 Drill Bit	Center Punch	



For Technical Support / Warranty Information please call **800-776-0767** or email info@smittybilt.com
1017 W 600 N, STE 4, Ogden, UT 84404

Box Contents

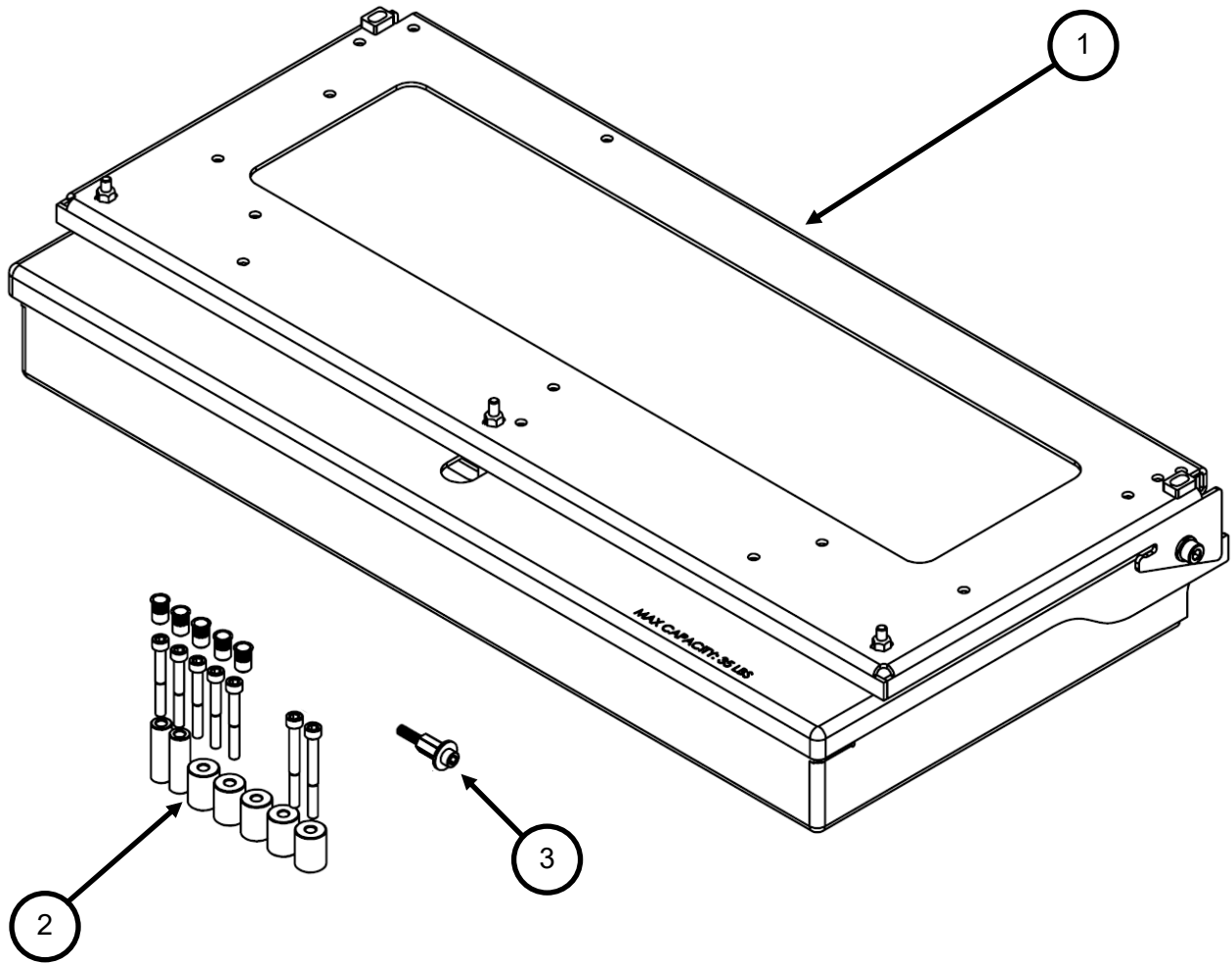

Item	Description	QTY
1	Tailgate Table	1
2	Mounting Hardware Pack	1
3	Nutsert tool	1



For Technical Support / Warranty Information please call **800-776-0767** or email info@smittybilt.com
 1017 W 600 N, STE 4, Ogden, UT 84404

Hardware Packs

Item	Description	QTY
2	Mounting Hardware Pack	1
	M6x1.0x60mm SHCS	2
	M6x1.0x50mm SHCS	5
	1.58" x 0.5" x 0.25" Spacer (for JL)	2
	1" x 0.75" x 0.25" Spacer (for Bronco/JK)	5
	Nutsert M6x1.0 LRG Flange Ribbed ZNC Plate Steel	5
3	Nutsert Tool	1
	M6x1x40mm SHCS	1
	M6 washer	1
	M6x0.75" Hex Spacer	1

Bolt Patterns

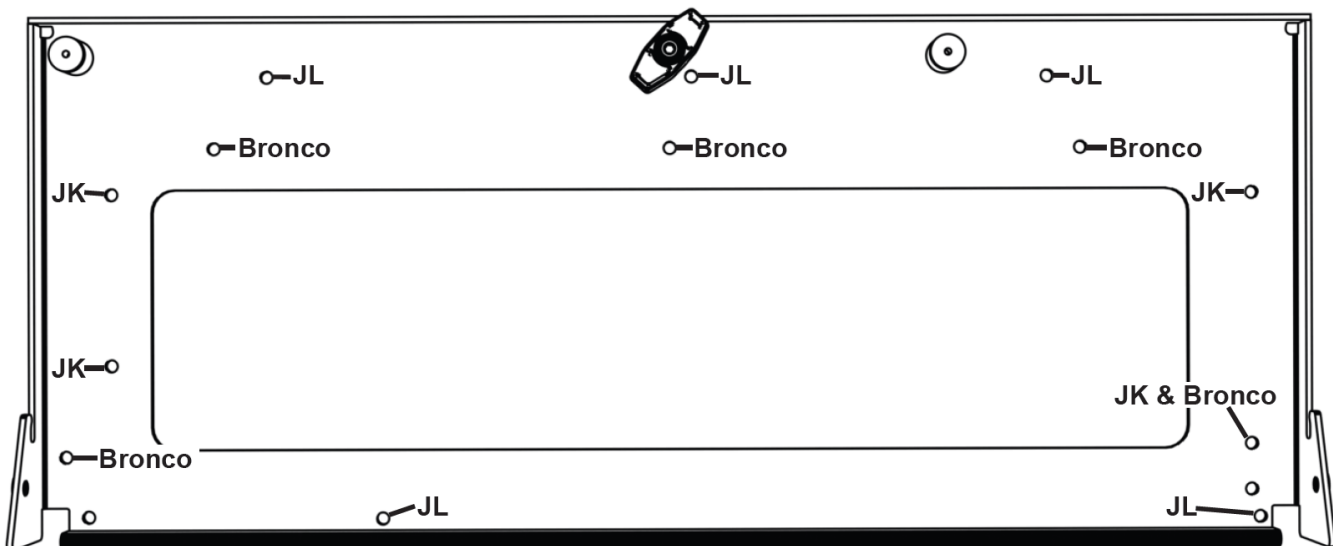

For Technical Support / Warranty Information please call **800-776-0767** or email info@smittybilt.com
 1017 W 600 N, STE 4, Ogden, UT 84404

JL® Installation Instructions

Step 1: Swing gate panel removal

Remove swing gate panel with a pry tool. Remove the upper plastic hole cover by pressing in tabs indicated below.

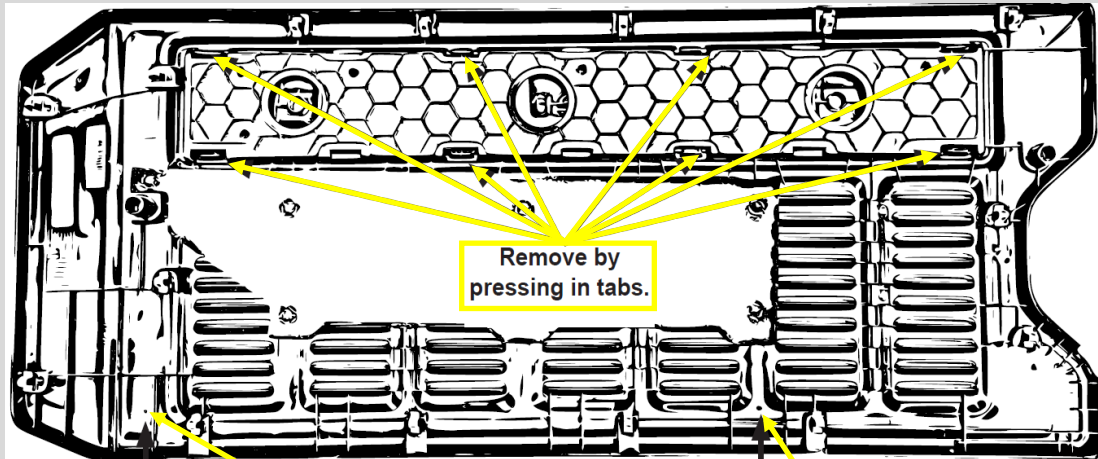

Step 2: Drill Holes

Drill a 9/16" hole at both of the pre-marked locations on the back of the swing gate panel.

Reinstall the swing gate panel without the plastic hole cover.

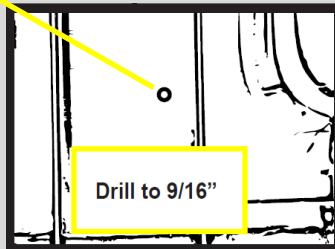

Step 3: Install Tailgate Table

Open the table. Loosely thread in three (3) M6x1.0x50mm bolts along with 1" spacers into the top three mounting holes. Close the table. Loosely thread in two (2) M6x1.0x60mm bolts along with 1.58" spacers into the bottom two holes. Spacers go between tailgate table and tailgate. Tighten hardware to the specifications outlined at the end of these instructions.

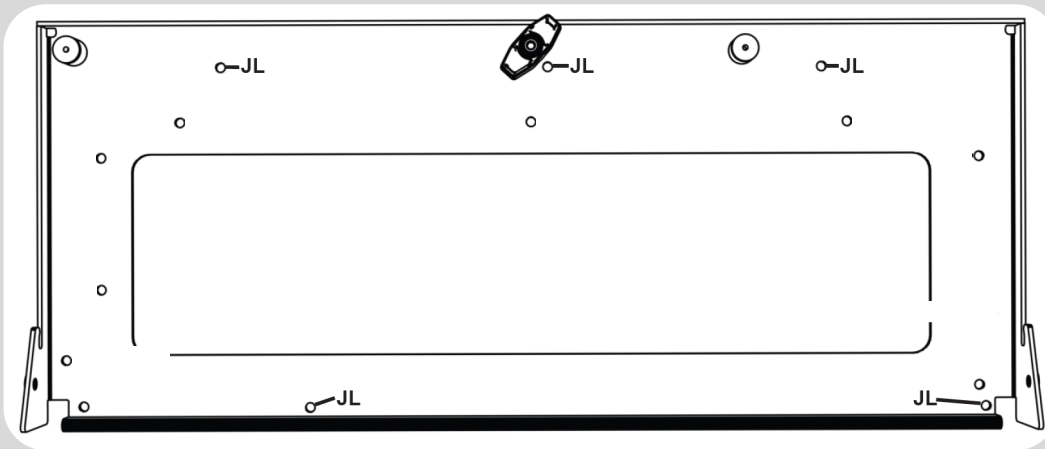

For Technical Support / Warranty Information please call **800-776-0767** or email info@smittybilt.com
1017 W 600 N, STE 4, Ogden, UT 84404

JK/Bronco® Installation Instructions



Step 1: Mark and Drill Mounting Holes

Align the template as indicated on the top and left side of the template and tape it to your tailgate.

Center punch each of the holes indicated for your vehicle.

Use a 23/64" bit to drill each hole indicated for your vehicle. We recommend using a bit depth stop to prevent drilling too far.



Step 2: Use provided tool to install rivet nuts

Using the provided M6x1.0x40mm bolt, hex spacer, and washer, assemble the tool.

Thread a rivet nut onto the bolt with the rivet nut flange against the washer. Place the rivet nut into one of the drilled holes and tighten the bolt while holding the hex spacer still with a wrench. Tighten the bolt until the rivet nut collapses completely and doesn't rotate in the hole.



Step 3: Install Tailgate Table

Open the table. Use the appropriate amount of M6x1.0x50mm bolts and 1" spacers for your vehicle in the appropriate bolt holes.

Make sure the spacers are placed between the tailgate table and tailgate.

Thread each bolt in loosely until all bolts are in, then tighten each bolt down completely.

Tighten all hardware to spec.

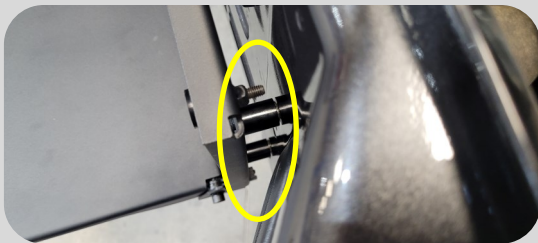

For Technical Support / Warranty Information please call **800-776-0767** or email info@smittybilt.com
1017 W 600 N, STE 4, Ogden, UT 84404

Installation Complete



Congratulations! Your installation is now complete.

Enjoy your new Smittybilt Tailgate Table



For Technical Support / Warranty Information please call **800-776-0767** or email info@smittybilt.com
1017 W 600 N, STE 4, Ogden, UT 84404

Bolt Torque Specifications

Use this only as a guide for hardware without a called out torque specification in the instruction manual.

Bolt Torque and ID						
Decimal System			Metric System			
<i>All Torques in Ft. Lbs. Maximums</i>						
Bolt Size	Grade 5	Grade 8	Bolt Size	Class 9.8	Class 10.9	Class 12.9
5/16	15	20	M6	5	9	12
3/8	30	45	M8	18	23	27
7/16	45	60	M10	32	45	50
1/2	65	90	M12	55	75	90
9/16	95	130	M14	85	120	145
5/8	135	175	M16	130	165	210
3/4	185	280	M18	170	240	290

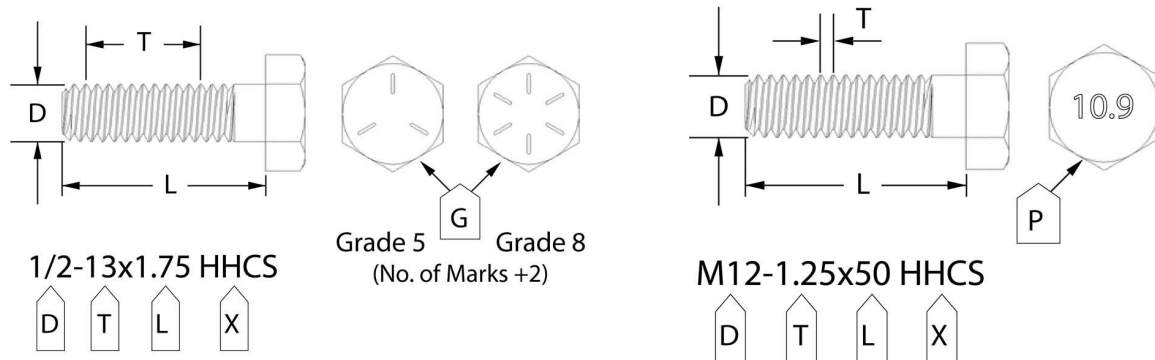

G= Grade (Bolt Strength)
 D= Nominal Diameter (Inches)
 T= Thread Count (Threads per Inch)
 L= Length (Inches)
 X= Description (Hex Head Cap Screw)

P= Property Class (Bolt Strength)
 D= Nominal Diameter (Millimeters)
 T= Thread Pitch (Thread Width, mm)
 L= Length (Millimeters)
 X= Description (Hex Head Cap Screw)



For Technical Support / Warranty Information please call **800-776-0767** or email info@smittybilt.com
 1017 W 600 N, STE 4, Ogden, UT 84404

Notes and Disclaimers

Product cleaning and maintenance instructions

Stainless Steel Finish – Aluminum polish may be used to polish small scratches and scuffs on the finish. Mild soap, window or glass cleaner may be used to clean the finish. Dual state powder coat finish – Mild soap, window or glass cleaner may be used to clean the finish. In order to protect the finish, you may wax your product on a regular basis with pure carnauba automotive wax. Do not use any types of soap, polish or wax that contains abrasive that could damage the finish. Textured coated finishes should be cleaned with a mild soap on a damp sponge. Do not apply polish or wax that requires to be removed by means of buffing. This type of wax is commonly used at car wash facilities. Chrome Finish – Mild soap, window or glass cleaner may be used to clean the finish. In order to protect the finish, you should wax your product on a regular basis with pure carnauba automotive wax. Do not use any types of soap, polish or wax that contains abrasive that could damage the finish.

SMITTYBILT ADVANTAGE WARRANTY

LIMITED-LIFETIME WARRANTY FOR STRUCTURAL COMPONENTS

5-YEAR FINISH WARRANTY

Smittybilt Automotive Products, LLC (SAP) warrants to the original purchaser that (a) the physical components (e.g., metal components, welds, etc.) of any SAP **JK/JL/Bronco Tailgate Table** will be free of defects in material and workmanship for the lifetime of the product from the date of purchase of the Tailgate Table, and (b) the finish will be free of defects in material and workmanship for a period of 5-years from the original date of purchase. This warranty applies only to the original purchaser of the Tailgate Table and is non-transferable. To obtain any warranty service, you must provide SAP with a proof of purchase and date of purchase that is acceptable to SAP, such as a copy of your purchase receipt.

This warranty does not cover labor of part replacement of the Tailgate Table. SAP will, at its sole discretion, provide replacement part(s) for a defective Tailgate Table or component, provided this is done within the warranty period. To request assistance under warranty, one must call or email using the phone number or email at the bottom of this page. This warranty does not apply (1) wearable components; or (2) if the Tailgate Table has been damaged, including, but not limited to: abuse, misuse, collision, modification, misapplication, improper installation, or improper service. This warranty is void if any SAP serial number has been removed or defaced; or if the Tailgate Table is used for any commercial, industrial, or rental applications. This warranty only applies to Tailgate Tables bought, sold, and used within the United States or Canada unless otherwise specifically agreed in writing by SAP.

THE WARRANTY SET FORTH ABOVE IS THE ONLY WARRANTY. THERE ARE NO OTHER WARRANTIES, EXPRESSED OR IMPLIED, INCLUDING BUT NOT LIMITED TO IMPLIED WARRANTIES OF MERCHANT ABILITY OR FITNESS FOR A PARTICULAR PURPOSE. ANY IMPLIED WARRANTY WHICH BY LAW MAY NOT BE EXCLUDED IS LIMITED TO A DURATION OF ONE (1) YEAR FROM THE DATE OF ORIGINAL RETAIL PURCHASE OF THE PRODUCT. No SAP dealer, agent, or employee is authorized to make any modification, extension or addition to this warranty. SAP SHALL NOT BE LIABLE FOR SPECIAL, INDIRECT, INCIDENTAL OR CONSEQUENTIAL DAMAGES (INCLUDING, BUT NOT LIMITED TO, LOST PROFITS, DOWN TIME OR LOSS OF USE) UNDER ANY LEGAL THEORY, EVEN IF SAP WAS ADVISED OF THE POSSIBILITY OF SUCH DAMAGES. Some states do not allow the exclusion of implied warranties or the exclusion or limitation of liability for incidental or consequential damages, or limitations on how long an implied warranty lasts, so the above limitation or exclusion may not apply to you. This Warranty gives you specific legal rights. You may also have other rights that vary from state to state. SAP reserves the right to change product design without notice. In situations in which SAP has changed a product design, SAP shall have no obligation to upgrade or otherwise modify previously manufactured products. For warranty inquiries contact SAP at:

Smittybilt Automotive Products, LLC

Customer Service Department

Call 1-800-776-0767 or Email info@smittybilt.com



WARNING: Cancer and Reproductive Harm
www.P65Warnings.ca.gov



For Technical Support / Warranty Information please call **800-776-0767** or email info@smittybilt.com
1017 W 600 N, STE 4, Ogden, UT 84404